

HARKEN®

INSTRUCTIONS

Loop Block

3214, 3230, 3245, 3255, 3386, 3387, 3388

N15W24983 Bluemound Road, Pewaukee, WI 53072-4974

Telephone: (262) 691-3320 • Fax: (262) 701-5780 • Web: www.harken.com • Email: harken@harken.com

WARNING! Strictly follow all instructions to avoid an accident, damage to your vessel, personal injury, or death. See www.harken.com/manuals for additional safety information.

 = Incorrect. Avoid to prevent accidents.

Parts



- 1) Head
- 2) Sideplates
- 3) Sheave
- 4) Deadend post
- 5) Mouth
- 6) Hex key
- 7) Blue Loctite® adhesive
- 8) Head securing line



Head securing line

Sideplate alpha

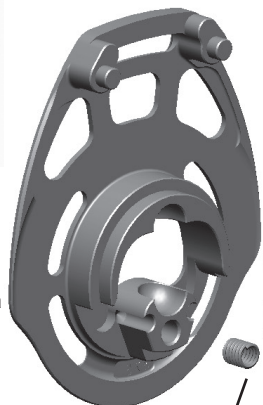

Deadend post

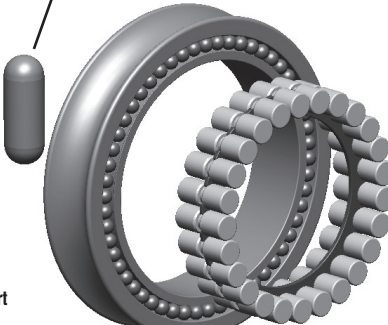

Sheave with side balls

Roller cage assembly

Heli-Coil® threaded insert



See 3386 double on next page

Sideplate beta

Isolator

Screw

Specifications

| Part No. | Sheave Ø | Max working load (MWL) | | Breaking load (BL) | | Max line Ø that fits through mouth |
|-------------------------|----------|------------------------|------|--------------------|------|------------------------------------|
| | | lb | kg | lb | kg | |
| 3214, 3386, 3387 | 57 mm | 2500 | 1134 | 5000 | 2268 | 5 mm |
| 3230, 3388 | 75 mm | 5000 | 2268 | 10000 | 4536 | 8 mm |
| 3245 | 100 mm | 7500 | 3402 | 15000 | 6804 | 11 mm |
| 3255 | 125 mm | 11000 | 4990 | 22000 | 9977 | 14 mm |

You Must Supply

Loop and/or high-strength lashing line

When choosing a Harken Loup® soft-attach, be sure the Loup maximum working load in basket configuration exceeds the maximum working load of the block.

When choosing a lashing line, use a breaking load that is double the block's breaking load to account for strength loss from:

1. Knots slipping or breaking at a much lower load than line breaking load. Spectra® or Dyneema®-type lines require specialized knots.
2. Splices slipping or failing due to incorrect type or execution.
3. UV damage increasing with each passing year.
4. Chafing seriously reducing strength.

Go to www.harken.com/knots for additional information. If you are not comfortable choosing line, work with a qualified rigger.

Note: See chart for maximum line diameter that will fit through mouth.



WARNING! Knots weaken line considerably. Consult qualified rigger or line manufacturer for advice on securing line. Use high-strength loops or consult rigger for recommendations on lashing. Using the wrong line, or securing the line improperly, can cause an accident.

Loctite is a registered trademark of Henkel AG & Company KGaA.
LOUP is a registered trademark of Yale Cordage.
Spectra is a registered trademark of Honeywell International, Inc.
Dyneema is a registered trademark of DSM Dyneema.
Heli-Coil is a registered trademark of Emhart Technologies Inc., Worldwide

| Block | Sheave Ø | Head securing line | Sideplate alpha | Heli-Coil | Deadend post | Sheave w/side balls | Roller cage assembly | Sideplate beta | Isolator | Screw | |
|-------------|----------|--------------------|-----------------|------------------------------------|--------------|---------------------|-----------------------|----------------|----------|---------|---------|
| 3214 | 57 mm | HCP1438 | AL-3700 | Alpha sideplate includes Heli-Coil | MS-210 | AL-3238 | H-34389A | HBB85 | AL-3701 | MP-3020 | HFS796 |
| 3387 | 57 mm | HCP1438 | H-85960 | | MS-210 | AL-3238 | H-85962 + (88) MP-124 | HBB85 | H-85961 | MP-3020 | HFS796 |
| 3230 | 75 mm | HCP1419 | AL-3726 | | MS-221 | AL-3336 | H-34390A | HBB86 | AL-3727 | MP-3021 | HFS806 |
| 3388 | 75 mm | HCP1419 | H-85872 | | MS-221 | AL-3336 | H-85875+ (96) MP-119 | HBB86 | H-85873 | MP-3021 | HFS806 |
| 3245 | 100 mm | HCP1419 | AL-3751 | | MS-251 | AL-3427 | H-34391A | HBB87 | AL-3752 | MP-3022 | HFS1271 |
| 3255 | 125 mm | HCP392 | AL-3769 | | MS-259 | AL-3515 | H-34392B | HBB88 | AL-3770 | MP-3023 | HFS1275 |

#5004 rev1

4 page booklet instruction

Final folded size: 4.25 x 5.5"

Black ink only

Prints all four pages

3386 Double Block Parts

Double block uses all components of single and a center plate.

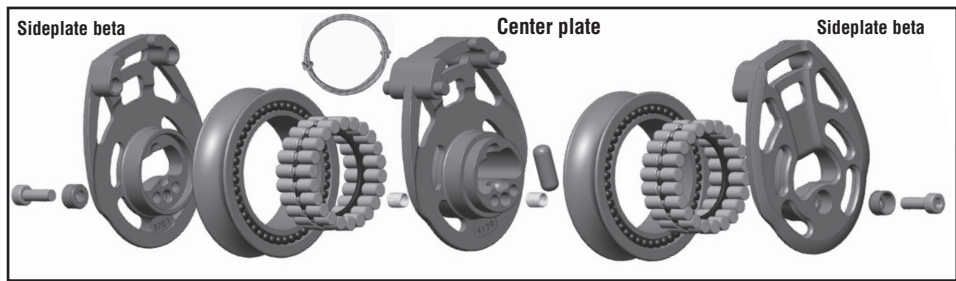

| Block | Sheave Ø | Screws | Isolators* | Sideplate beta | Roller cage assemblies | Sheaves w/side balls | Deadend post* | Helicoil® | Center plate | Head securing line |
|-------|----------|------------|-------------|----------------|------------------------|----------------------|---------------|------------|--------------|--------------------|
| 3386 | 57 mm | (2) HFS796 | (2) MP-3020 | (2) AL-3701 | (2) HBB85 | (2) H-34389A | AL-3238 | (2) MS-210 | AL-3700 | HCP1438 |

* AL-3701 sideplates include isolators. AL-3700 center plate includes Helicoil threaded inserts.

Terminating to Deadend Post



WARNING! Webbing or smaller lashings can be damaged by being pinched between post and sideplate. Damaged webbing or lashings can part suddenly under load. Use only loops when terminating at deadend post.

Terminating to deadend post lets you attach block to a closed bail such as a padeye.

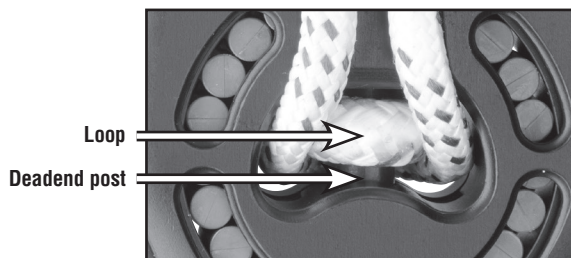

1. Remove screw.



2. Remove deadend post. Remove plate on post side to deadend to double.

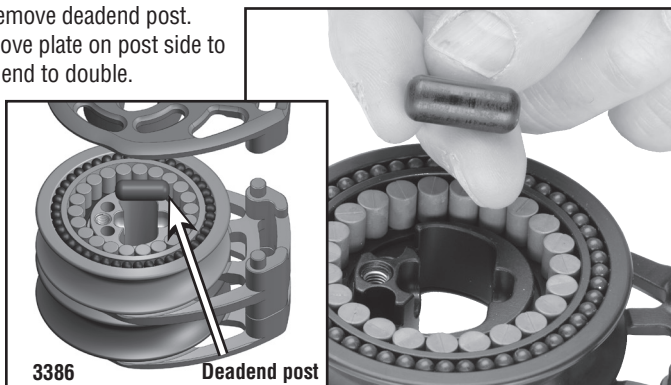

3. Insert loop into block mouth as shown.



4. Pass loop ends through mouth so loops extend beyond block's sideplates as shown.



5. Open sideplates without pulling line through block.



Tip: With shorter loops, place loop at the side of the head to allow more room to insert the deadend post.

6. Part legs of loop and insert deadend post. Make sure deadend post is seated straight in sideplate. Put sideplates together.

Deadend post

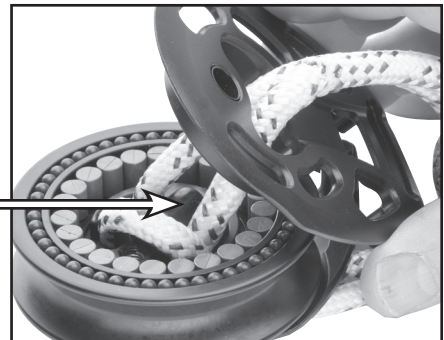

7. Pull loops to seat ends on deadend post.



8. Reassemble block using blue Loctite® adhesive on screw.



9. Secure loop to head of block with head securing line using a Carrick bend. For knot tying resources: www.harken.com/knots.

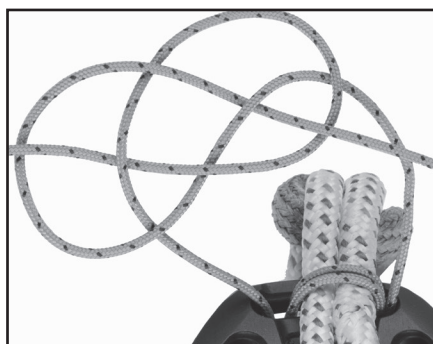

10. Further secure knot by carefully melting line ends with a hot knife.



WARNING! If head-securing line comes loose, block can flip and cause line to jam, resulting in loss of control. Inspect head-securing line often and redo if necessary.



Terminating Loop Outside Block or Using Lashing

If terminating line outside block or lashing using multiple strands of smaller-diameter line, remove the deadend post.

1. Use hex key to remove screw.



Loctite is a registered trademark of Henkel AG & Company KGaA.

2. Remove deadend post.

Do not use post with multiple lashing lines.

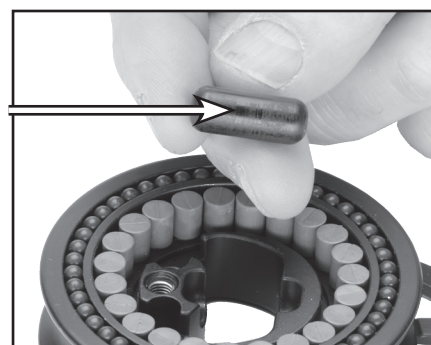

3. Reassemble block. Use blue Loctite® adhesive on screw.

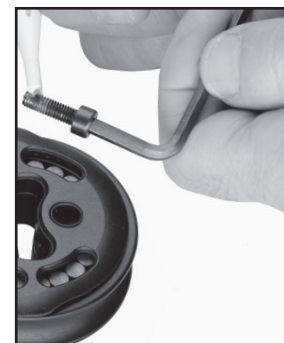

4. Lash or run loop through mouth of block.

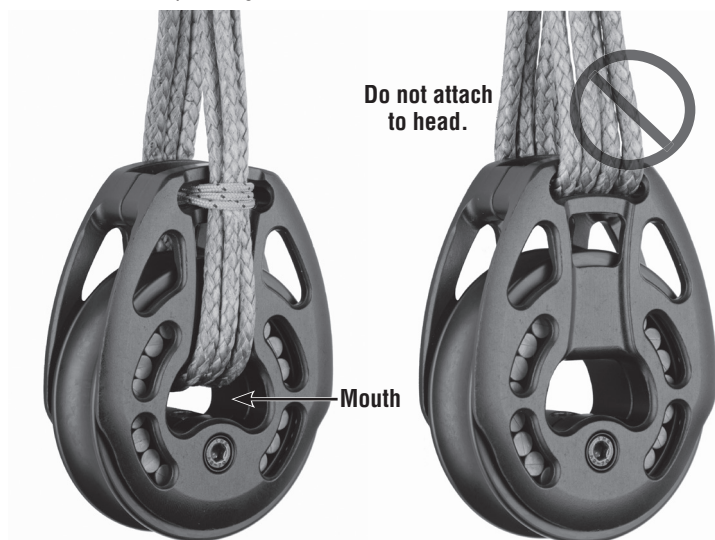

WARNING! Attaching line to block head will considerably weaken block so it can easily break under load. Attach loop/lashing only through mouth of sheave.

5. Secure lashings or loop to the head using a securing line tied in a Carrick bend. For knot tying resources: www.harken.com/knots



Loctite is a registered trademark of Henkel AG & Company KGaA.

! WARNING! Using a loop in a “choker-style” weakens the loop connection. Do not use choker-style connection.



Choker

ALL INSTALLATIONS
Anchor Point Chafing or Cutting

! WARNING! Loops or lashings running over a sharp edge can cause part to break under load. Attach to fitting with a rounded edge.

Loops must be attached to round bails such as those found on padeyes or pins. Sharp edges on many perforated toerails will cut loop, severely weakening it. When loop is attached to a plate, it must be at least 25 mm (1/4") thick and have rounded edges to keep loop from being damaged.

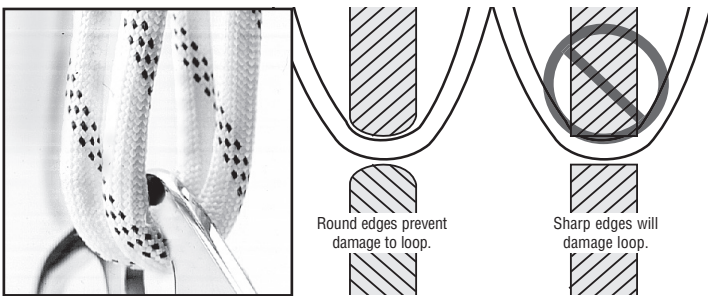

Inspect Parts Every Time you Sail

! WARNING! Failure to inspect block, loops, and lashing, and correct any problems, may result in block breaking under load. Inspect parts each time you sail. If blocks are under load during long passages inspect them carefully while in use.

1. Inspect block to make sure that screw is secure. If screw is loose, remove it. Apply blue Loctite® adhesive and retighten.



3. Inspect loops and lashings. Replace if there are signs of wear, or if the colored tracer fades from UV damage. Pull loop out of mouth and inspect loop/lashing carefully for any signs of wear, UV damage, fatigue, or strand separation. Replace loop if it shows signs of UV damage or wear.

! WARNING! Failure to replace damaged or weakened parts can cause block to break under load. Replace all loops and lashings every year or if there is any sign of wear, UV damage, fatigue, or strand separation. If in doubt, replace. Consult chart to match strength of loop/lashing to block and load.

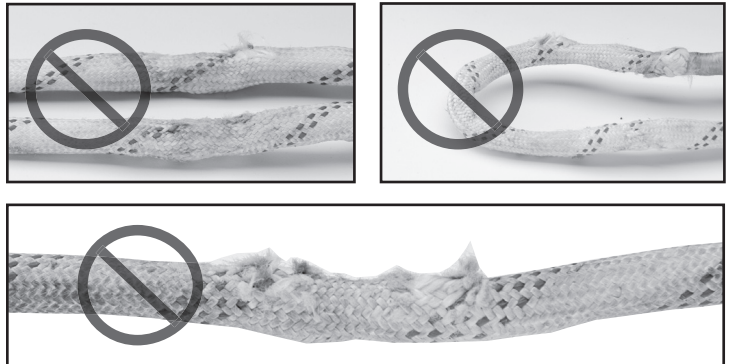

4. Inspect head securing line to make sure knot is holding tightly.

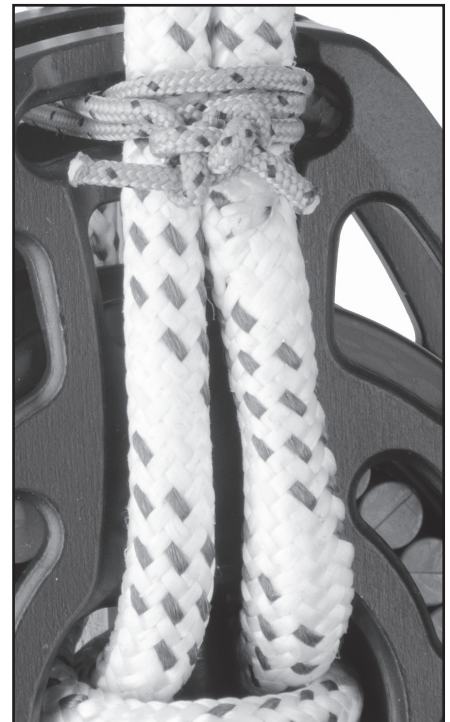

Loctite is a registered trademark of Henkel AG & Company KGaA.

Maintenance

Harken equipment is designed for minimal maintenance, but some maintenance is required to give the best service and to comply with the Harken limited warranty.

Cleaning: Flush blocks, loops and lashing lines thoroughly with fresh water. Periodically, disassemble the blocks and clean with detergent and fresh water. When assembling block, make sure screws and holes are dry. Use blue Loctite adhesive to secure screw before assembling.

IMPORTANT! Exposure to some teak cleaners and other caustic solutions can result in discoloration of part and is not covered under the Harken warranty.

Warranty

For additional safety, maintenance, and warranty information: www.harken.com/manuals or the Harken catalog.